

TECHNICAL SPECIFICATION

MODEL	OPENINGS	VOLUME (Ltrs.)	DIMENSIONS (mm)										BASE	WEIGHT OF VESSEL WITH BASE (Kg)	
			D1	D	H±10	H1	H2	L	F	WA	WLA	WB			WLB
14X65	4" TOP AND BOTTOM	145.7	360	370	1865	1630	1390	280	100	6.5	3	6.5	2	Tri-pod	19.4

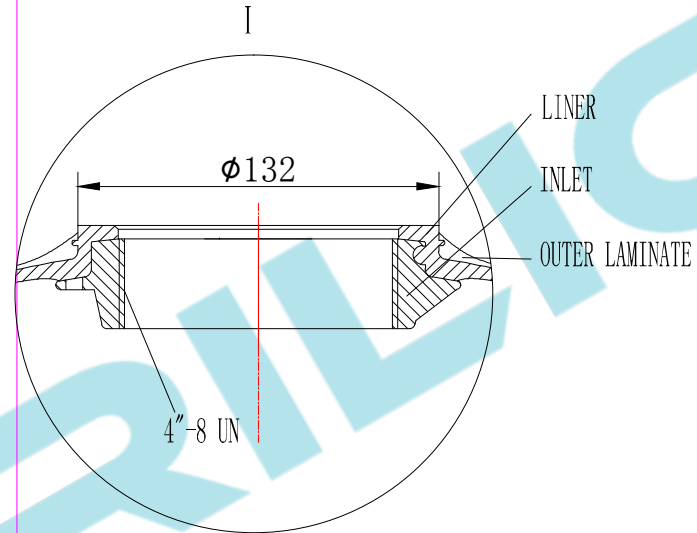
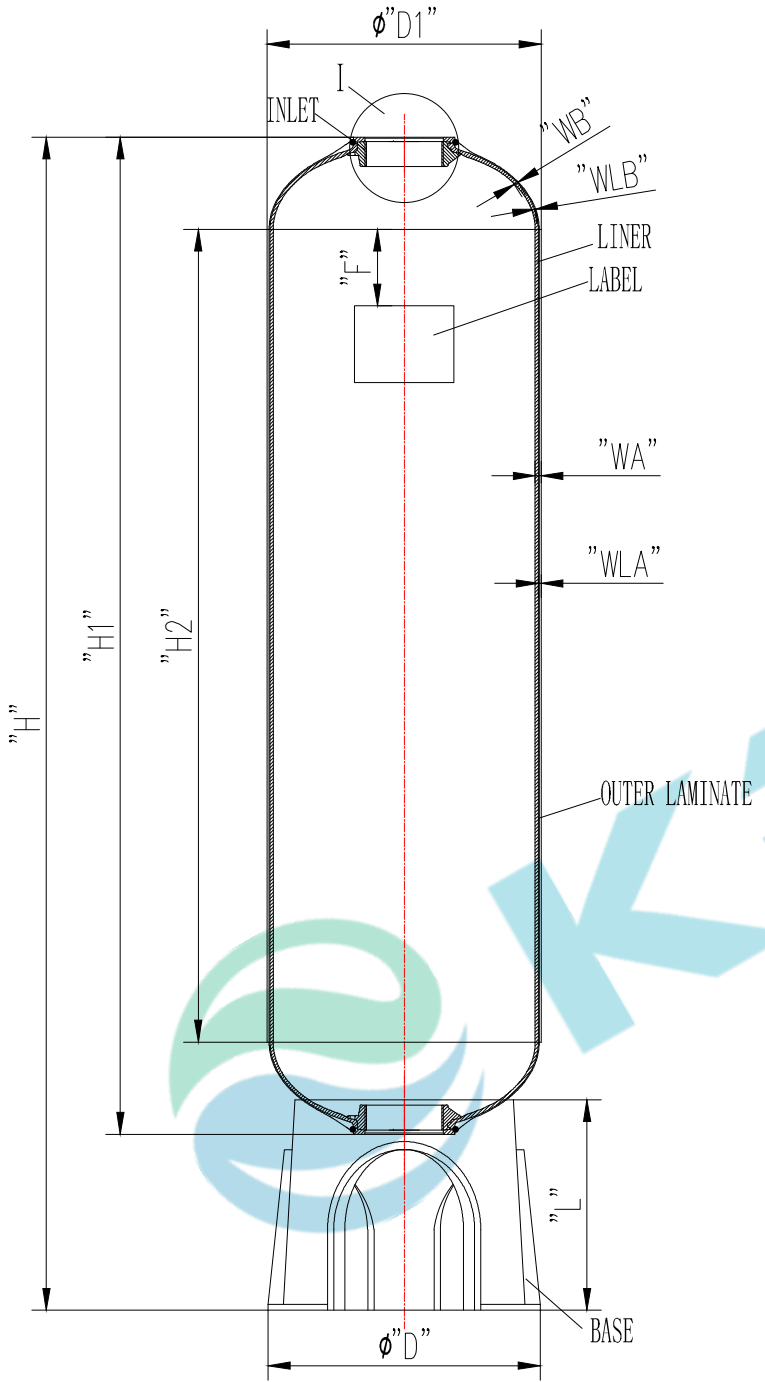

4"-8UN Internal Thread	
PITCH DIA	3.918-3.930"
MINOR DIA	3.865-3.875"
MAJOR DIA	4.000-4.010"

NOTES:	
1. TANK MUST MEET ALL APPLICABLE SPECIFICATIONS OF NSF/ANSI 044 STANDARD, LATEST REVISION.	
2. OPERATING SPECIFICATIONS:	
A. MAXIMUM WORKING PRESSURE:	10.5BAR (150PSI)
B. TEMPERATURE RANGE:	1-50°C (34-122°F)
C. MAXIMUM VACUUM:	17KPa (5" Hg)

	NAME	DATE	VERSION NO.	CHANGING DESCRIPTION	CHANGING DATE
DESIGN					
INSPECTION			INDUSTRIAL VESSEL		
APPROVAL			MODEL: 14" (4" TOP AND BOTTOM)	DRAWING NO.	NV-WI-DR-TE-PR-SA-VE0014404
			MATERIAL: FRP UNIT: mm	VERSION NO. 1.1	TOTAL PAGE 1 OF 1 DO NOT MEASURE THE DIMENSIONS.